

**CITY OF SNOHOMISH  
Snohomish, Washington**

**ORDINANCE 2164**

**AN ORDINANCE OF THE CITY OF SNOHOMISH, WASHINGTON,  
ADOPTING THE ANNUAL DOCKETED CHANGES TO THE  
COMPREHENSIVE PLAN FOR 2008 AND AMENDING ORDINANCE  
1866, AS AMENDED**

**WHEREAS**, as one of the cities in Snohomish County, the City of Snohomish is required to adopt and regularly update a comprehensive plan pursuant to the Washington State Growth Management Act (GMA); and

**WHEREAS**, under the GMA, the City is authorized to amend its Comprehensive Plan on an annual basis; and

**WHEREAS**, the Comprehensive Plan was thoroughly reviewed and substantially revised in 2005 to ensure conformance with GMA requirements, and was subsequently amended in 2006 and 2007; and

**WHEREAS**, for 2008, the City has reviewed the proposed amendments to the Comprehensive Plan Land Use Designation Map for internal consistency; and

**WHEREAS**, acting as the City of Snohomish SEPA Responsible Official, the City Planning Director reviewed the proposed amendments and issued a Determination of Non-significance (DNS); and

**WHEREAS**, the City has conducted a broad process of public participation to review proposed amendments to the Comprehensive Plan; and

**WHEREAS**, on October 1, 2008, a public hearing on the proposed amendments was held by the Planning Commission, and all persons wishing to be heard were heard; and

**WHEREAS**, on December 2, 2008, a public hearing on the proposed amendments was held by the City Council, and all persons wishing to be heard were heard; and

**WHEREAS**, public notice of the SEPA DNS and the public hearings was provided as required by law; and

**WHEREAS**, pursuant to SMC 14.15.070 and RCW 36.70A.106, the City has notified the Washington State Department of Community, Trade, and Economic Development of the City's intent to adopt the proposed amendments to the Comprehensive Plan; and

**WHEREAS**, the Planning Commission and the City Council have found that the Comprehensive Plan amendments adopted in this ordinance are:

1. Internally consistent with the Comprehensive Plan;
2. Consistent with the Growth Management Act and the State Environmental Policy Act; and
3. In the interest of the public health, safety, and welfare of Snohomish residents;

**NOW THEREFORE, THE CITY COUNCIL OF THE CITY OF SNOHOMISH, WASHINGTON DO HEREBY ORDAIN AS FOLLOWS:**

Section 1. Application 06-08-001-CPA.

Ordinance 1866, as amended, and the Land Use Designation Map of the City of Snohomish Comprehensive Plan are hereby amended as set forth in the attached Exhibit A.

Section 2. Application 07-08-001-CPA.

Ordinance 1866, as amended, and the Land Use Designation Map of the City of Snohomish Comprehensive Plan are hereby amended as set forth in the attached Exhibit B.

Section 3. Application 08-08-001-CPA.

Ordinance 1866, as amended, and the Land Use Designation Map of the City of Snohomish Comprehensive Plan are hereby amended as set forth in the attached Exhibit C.

Section 4. Severability.

If any section, sentence, clause, or phrase of this Ordinance is held to be invalid or unconstitutional by a court of competent jurisdiction, such invalidity or unconstitutionality shall not affect the validity or constitutionality of any other section, sentence, clause, or phrase of this Ordinance.

Section 5. Effective Date.

This Ordinance shall take effect five days after its publication by summary.

**ADOPTED** by the City Council and **APPROVED** by the Mayor this 2<sup>nd</sup> day of December, 2008.

CITY OF SNOHOMISH

By \_\_\_\_\_  
RANDY HAMLIN, MAYOR

Attest:

Approved as to form:

By \_\_\_\_\_  
TORCHIE COREY, CITY CLERK

By \_\_\_\_\_  
GRANT K. WEED, CITY ATTORNEY

**Exhibit A  
Ordinance 2164  
06-08-001-CPA**

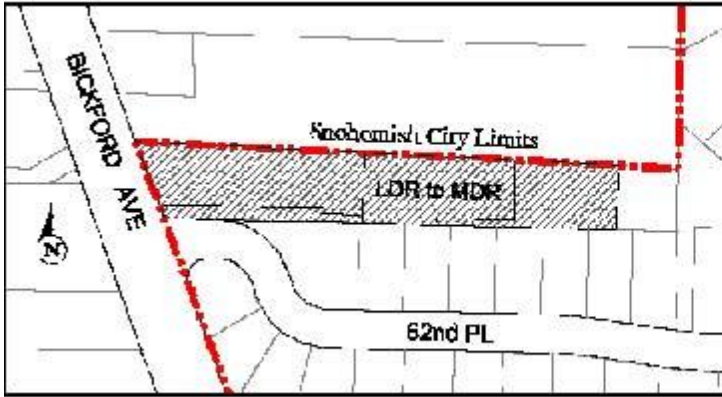

**Map Change from Low Density Residential  
to Medium Density Residential**

**Tax Parcels**

28050100401200  
28050100402600  
28050100402400  
28050100402500

--- CITY LIMITS  
--- UGA BOUNDARY  
--- HISTORIC DISTRICT BOUNDARY

**RESIDENTIAL**

- SINGLE FAMILY
- LOW DENSITY RESIDENTIAL
- MEDIUM DENSITY RESIDENTIAL
- HIGH DENSITY RESIDENTIAL

**COMMERCIAL**

- COMMERCIAL
- MIXED USE
- BUSINESS PARK
- HISTORIC BUSINESS

**INDUSTRIAL**

- INDUSTRY
- AIRPORT INDUSTRY

**OTHER**

- OPEN SPACE
- URBAN HORTICULTURE
- PUBLIC

**Exhibit B  
Ordinance 2164  
07-08-001-CPA**

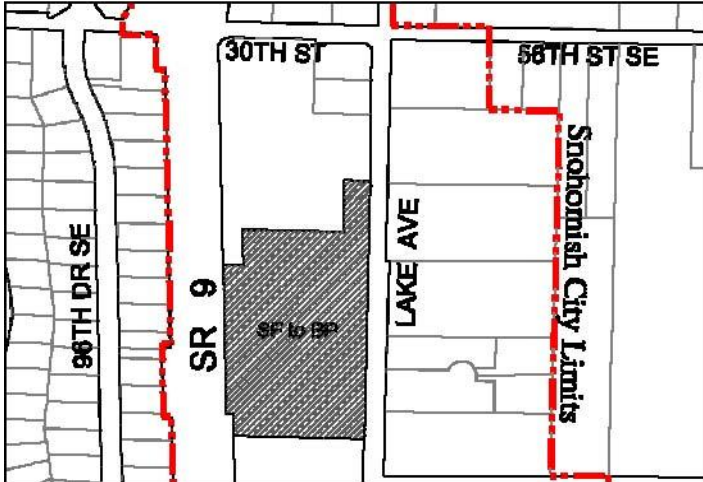

**Map Change from Single Family  
Residential to Business Park**

**Tax Parcels**  
28050100107000

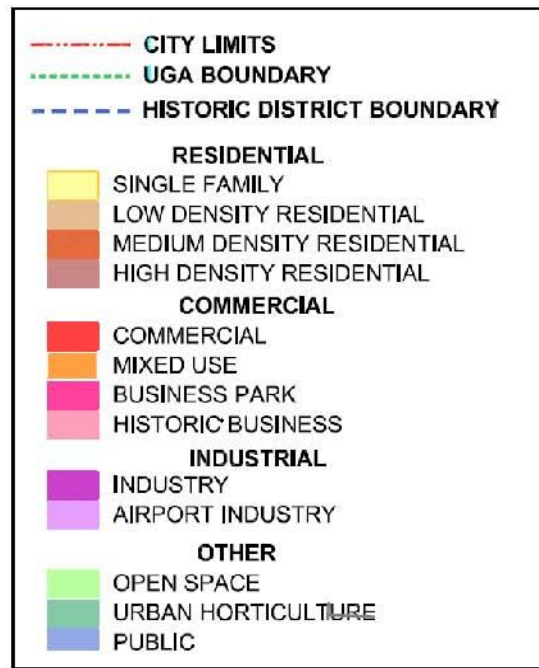

**Exhibit C  
Ordinance 2164  
08-08-001-CPA**

Page 1 of 2

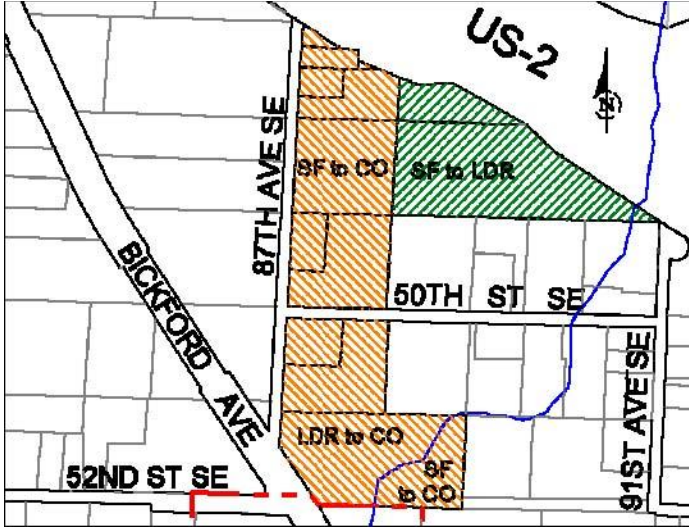

**Map Change from Single Family Residential and Low Density Residential to Commercial and Low Density Residential**

**Tax Parcels**

- 00440100001700
- 00440100001801
- 00440100001802
- 00440100002104
- 00440100002101
- 00440100002200
- 00440100002304
- 00440100002301
- 00440100002303
- 00440100002305

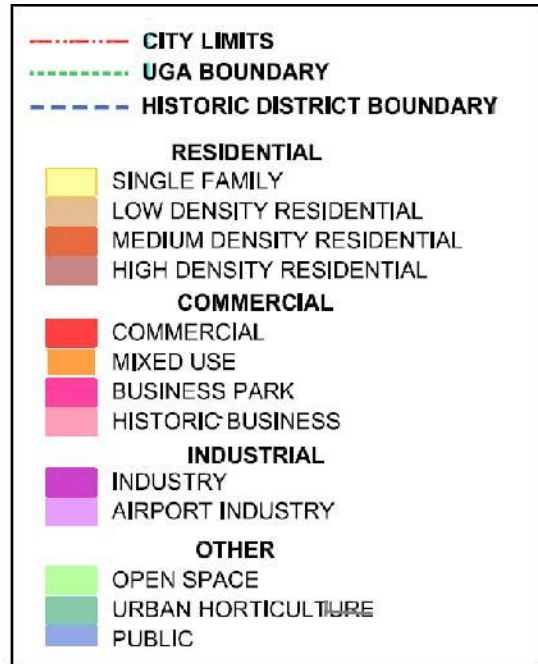

**Exhibit C**  
**Ordinance 2164**  
**08-08-001-CPA**  
**Page 2 of 2**

